



## 40-50 SOFT MOUNT

*Field-tested and widely deployed, this system is adaptable to land and sea platforms.  
Compatible with the M2/M3 tripod for dismounted operations.*

### KEY FEATURES

- Maintenance-free operation and integrated ammunition can holder.
- Adjustable elevation and depression tension with 10° Initial Depression Stop.
- Compatible with G3 cone receiver, MK16 MOD8 cone and twin weapons.
- Bi-directional recoil-attenuation for improved control and accuracy.

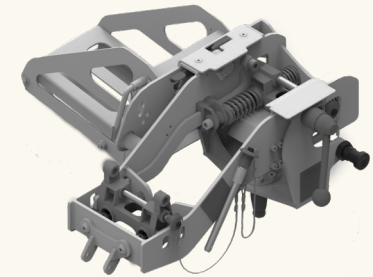

“  
**SMOOTH OPERATION**  
**RUGGED CONSTRUCTION**  
”

### TECHNICAL SPECIFICATIONS

Weapons Compatibility:	M2HB 12.7mm; M3D High-speed .50 Cal; MAG58/M240, Minimi/M249; MK19 40mm AGL; H&K GMG; MK47; M60; PKM; MG3, MG4, MG5; LAG40; CIS-40.
Weapon Mount Interface:	M3 NATO Pintle/ MK16 MOD8 Pintle, G3/2 Groove Pintle, HD Marine Pintle with rotation stop.
Ammunition Compatibility (Standard NATO Ammo Liner):	M2/M3D 12.7mm HMG (100rds), Mk19/HK GMG 40mm AGL (32rds), Mag58/MINIMI 7.62 GPMG (200/230rds), MINIMI 5.56 SAW (200rds).
Elevation:	+40°
Depression:	-10° Stop/ -30° Override.
Weapon Traverse:	360° (application dependent).
Mass:	23kg (excluding weapon and adaptor).
Part Number:	P10552-10 (Dependent on Mount).

## SOFT MOUNT ADAPTORS & ACCESSORIES

The Platt 40-50 Soft Mount integrates machine guns from 5.56mm up to 40mm. A range of gun adaptors are available to fit current weapons, as seen in the following table below;

ADAPTOR	WEAPON / CALIBER
No Adaptor Required:	M2 QCB HMG 12.7mm, M3D US Ordnance 12.7mm, Mk19 AGL 40mm, M2HB HMG 12.7mm.
M240 Adaptor (P10064):	Mag 58 GPMG 7.62mm (M240), MINIMI GPMG 7.62mm (Mk48), MINIMI 5.56mm SAW (M249), MG3/4/5 7.62mm GPMG (P10076-30 Adaptor).
M60 Adaptor (P10279):	M60 GPMG 7.62mm (M60).
PKM Adaptor (P10574-50):	PKM 7.62mm GPMG.
GMG Adaptor (P10423):	HK GMG 40mm AGL.
LAG40 Adaptor (P10196):	Santa Barbara AGL 40mm (LAG40).
Mk47 Adaptor (P10438):	Mk47 AGL 40mm (Mk47).
CIS 40 Adaptor (P10588):	CIS 40 AGL 40mm.

\*CUSTOMER CUSTOMISATIONS UPON REQUEST, ACCESSORIES AVAILABLE ON SEPARATE OFFERS OR COMBINATIONS.

